



149 Lakeview Road TARAGO, NSW 🛏️ 5 🚿 2

102 Acres Stunning 360 Degree Dividing Range Mountain & Lake Bathurst Water Vie

A special country escape, a rural retreat or simply an amazing place to call home in the most spectacular surroundings that will make you feel on top of the world.

It would be hard to compare this to any other location, situated on a secluded block at the end of a cul-de-sac, just 30 minutes from the booming City of Goulburn and within just 1 hour of the national capital, Canberra.

Come and enjoy the beauty of the countryside. Sit on the back verandah and watch the sun rise over the Budawang Range, watch storm clouds drift by over bushland views all the way to Palerang Peak, then enjoy spectacular sunsets before countless stars come out in the dark night sky, far removed from the lights of the city. Marvel at the spectacular variety of

Inspect: Sunday, 31st January 2021 1:00 - 2:00
Sunday, 7th February 2021 1:00 - 2:00

Paul Pace Country
0416128177
(NSW)

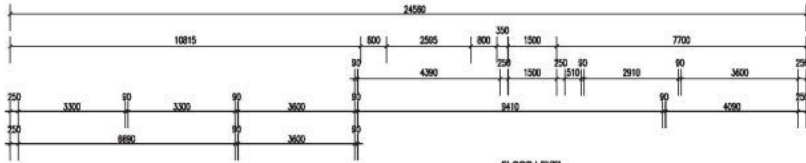

- FLOOR PLAN LEGEND:**
- EXHAUST FAN
 - SMOKE DETECTOR
 - DOWNPIPE LOCATION
 - MANHOLE (CEILING ACCESS)
 - ELECTRICAL METERBOARD (RBO)
 - HOT WATER SERVICE
 - BEAMS TO BE DESIGNED BY ENGINEER, BUT NOT LIMITED TO, AS DETERMINED BY ENGINEER'S STRUCTURAL ASSESSMENT.

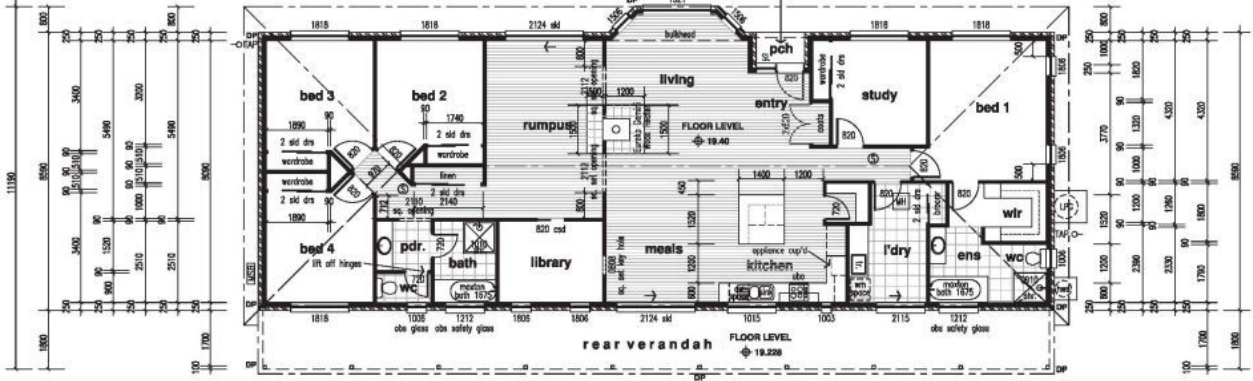

FLOOR PLAN
SCALE 1:100

residence	212.81 sqm
porch	1.50 sqm
ver.	43.66 sqm
TOTAL	257.97 sqm

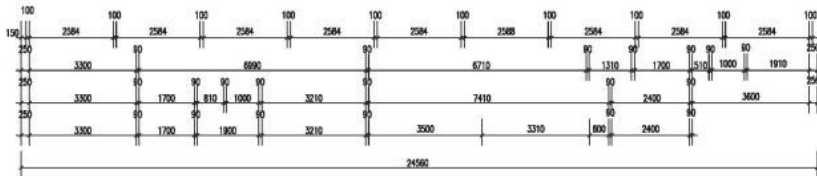

TIMBER FRAMING NOTE:
ALL TIMBER FRAMING TO BE IN ACCORDANCE WITH BCA 2006 AND COMPLY WITH AS1684 - 2006 & TIMBER FRAMING MANUAL

COMFORT PLUS TO ALL WINDOWS

149 Lakeview Road

TARAGO, NSW

