



335 Kardinia Road DOLLYS FLAT, NSW



154 Acres High Undulating Landscape With Creek Frontage, Large Dams, Lovely Stor

Perched high on a commanding hill side location quietly tucked away on a meandering and picturesque country road this amazing 154-acre property is the dream of many.

Featuring rolling hills, fertile creek flats, shady forests and stunning distant views of the local rural landscapes extending to breathtaking mountains and national parks in the far away distance of the horizon.

An outstanding weekender, getaway, artist retreat or hobby lifestyle farm set up and ready to enjoy!

All located just 7 minutes plus drive to Wingham township or 20 minutes to great facilitie

Paul Pace Country

0416128177
(NSW)

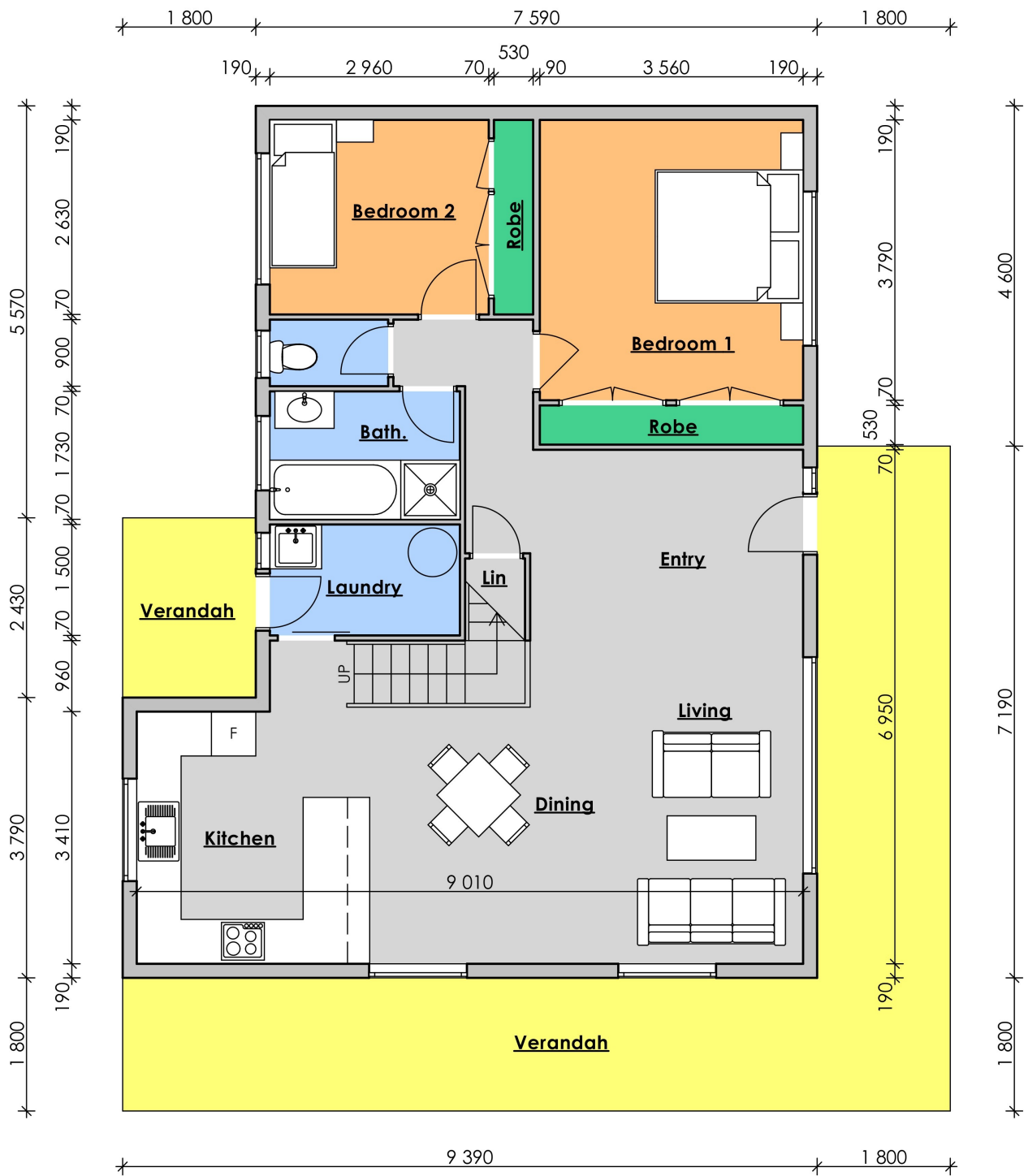

335 Kardinia Road

DOLLYS FLAT, NSW

